

Movie Set Design

There is no doubt that the design of the movie set truly does “set-the stage” for the movie. Millions of dollars are spent on the set of a movie, whether it is a physical or virtual set. Set designers need to have a clear vision and be able to explain to others working on the movie, what they want the final outcome to look like. Often times because of the close relation of the fields, architects become set designers because of their knowledge of the built environment.

Design Concept

Come up with a movie you would like to design a set for a scene in that movie. It can be a movie you completely made up or based on one already existing. (*However, if you select an existing movie, do not simply copy a set already designed, you will need to design your own.*) Once you select a scene in the movie and decide what will be happening in that scene you will write a few sentences explaining what you envision occurring in that scene. Knowing what you want movie goers to see and experience as they watch this scene will help you visualize your **design concept**.

The two pictures below both show a living room with a large window overlooking landscaping. However, they give off two varying feelings. This is because of the different use of styles, colors, varying landscaping beyond, the time of day, and the objects used.



The **design concept** is the visual metaphor for the movie and should be an integrated whole, rather than based on a piecemeal approach. This means don't just think about the set itself, think about the mood, the costumes, even the sounds that would be present. It will evoke a clear, immediate interpretation of the scene. Elements to consider could be:

main ideas
style
setting
atmosphere

characters
colors
images
words

symbols
objects
shapes and mood

Presentation

You will create a Presentation Board explaining your set design on given poster board. You will then present your board and ideas in front of the class.

Planning out your presentation is an essential component of the design process and should be given careful consideration. The presentation of the project should be clear, neat, artistic and methodical. Although you will be presenting it in front of the class, the presentation board should be able to explain its purpose without having someone explain it. You will be given some materials in class, however feel free to seek out additional resources (magazines, color printer, additional presentation board materials from home)

Presentation Requirements

Your Set Design Presentation Board should include the following:

- Title of the Movie and the stated “scene”.
- Your Set Design Concept statement.
- A hand sketched floor plan of your movie set
- At least one hand sketched perspective of your movie set
- Your name and date
- Any additional pictures, sketches, or information that will help get your idea across.
- Grammar and spelling, organization and neatness are important.

Materials Provided

Poster Board

Scissors

Markers, Colored Pencils, Crayons

Mylar for desk protection

Glue

Tape

Computers- Black and White Printer

Examples of set design floor plan and perspective sketches

V3 LAB FLOORPLAN 7-2-2012 S. HUMAN

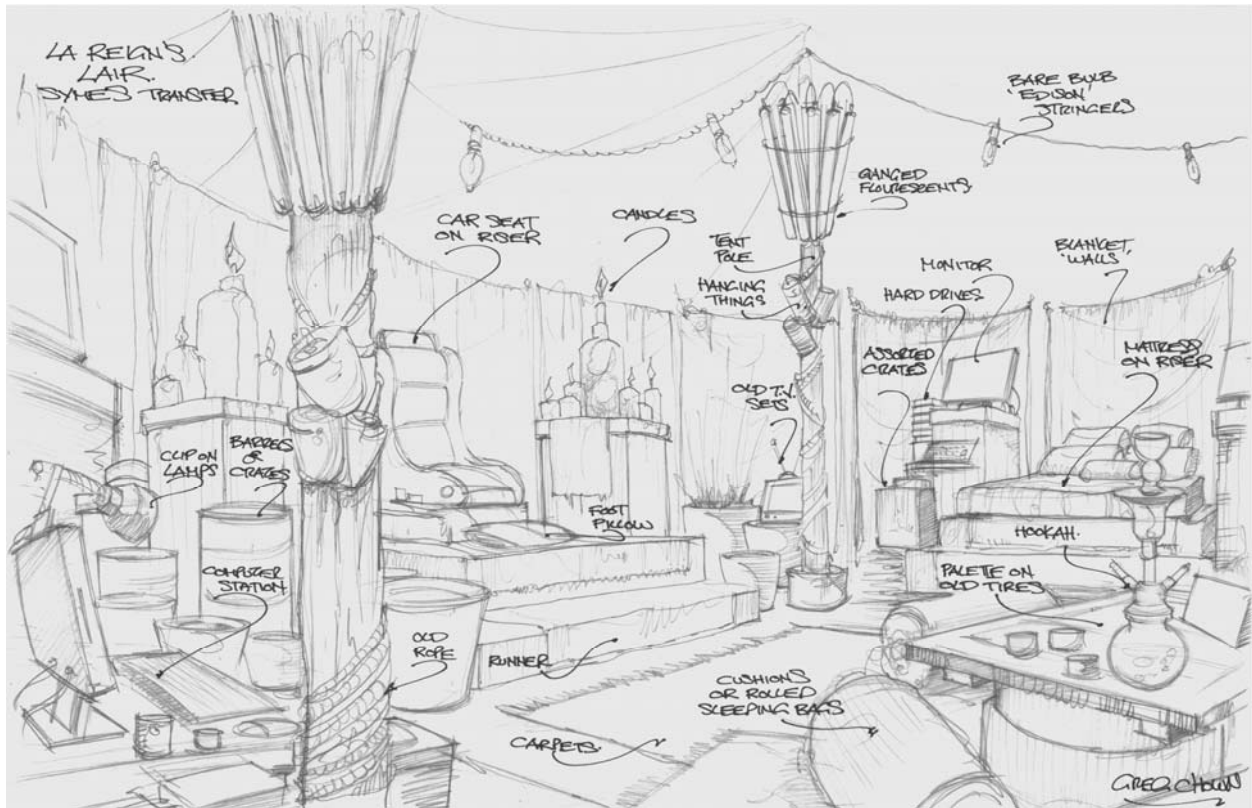
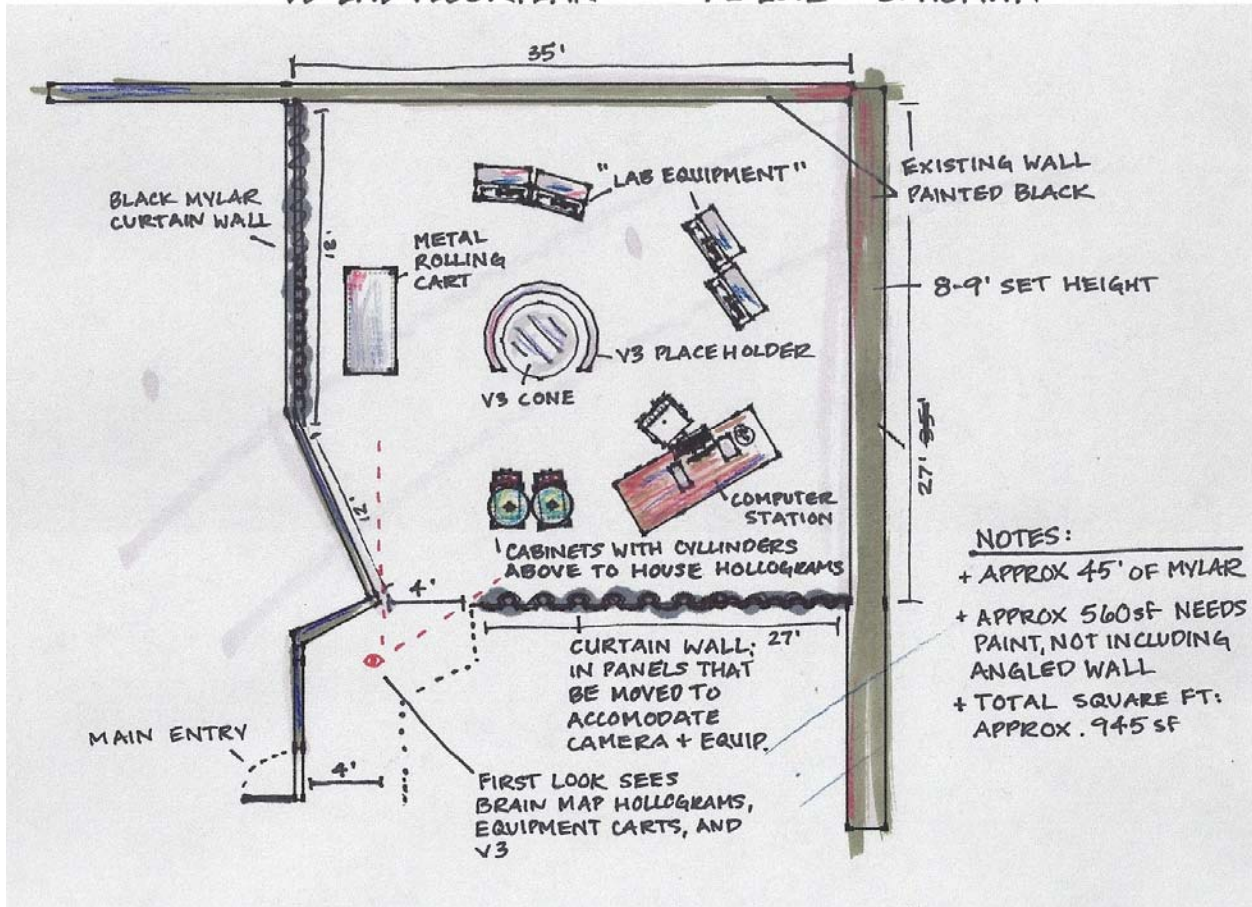

Movie Set Design

What is your scene and what is happening in it?

Write a few sentences explaining what you envision occurring in that scene. Knowing what you want movie goers to see and experience as they watch this scene will help you visualize your design concept.

Write a rationale describing your design concept. Explain your vision that you are designing for and even the approach you took, or how you developed and came up with your design. Remember your design concept provides a coherent vision of the scene that you are designing for and incorporates the previously listed elements.
