

**Guest House- Part 2**  
Project

Once you have drawn the Schematic Floor Plan of the Guest House you will need to add the following:

1. **Room Labels**
2. **Door and Window Tags**
3. **Dimensions/ Section Lines**
4. **Notes**
5. **Title and Scale**
6. **Wall Hatch**

You are given a copy of how the floor plan should look after you do all of the above. Below are some key rules you need to follow.

1. **ROOM LABELS:** *This plan will be printed out at a scale of* \_\_\_\_\_  
\_\_\_\_\_  
\_\_\_\_\_
2. **DOOR & WINDOW TAGS:** \_\_\_\_\_  
\_\_\_\_\_  
\_\_\_\_\_  
\_\_\_\_\_  
\_\_\_\_\_
3. **DIMENSIONS/ SECTION LINES:** \_\_\_\_\_  
\_\_\_\_\_  
\_\_\_\_\_  
\_\_\_\_\_  
\_\_\_\_\_
  - a. **EXTERIOR DIMENSIONS:** \_\_\_\_\_  
\_\_\_\_\_  
\_\_\_\_\_
  - b. **INTERIOR DIMENSIONS:** \_\_\_\_\_  
\_\_\_\_\_  
\_\_\_\_\_
  - c. **SECTION LINE:** *When you draw the section line, draw a line and put two elevation bubbles at the ends for the arrows. Label it "Section 01, A-00" you will update the sheet # shortly* \_\_\_\_\_  
\_\_\_\_\_
4. **NOTES:** \_\_\_\_\_  
\_\_\_\_\_
5. **TITLE AND SCALE:** \_\_\_\_\_  
\_\_\_\_\_
6. **WALL HATCH:** \_\_\_\_\_  
\_\_\_\_\_

Once you are complete with this step, your floor plan should look like the example given.

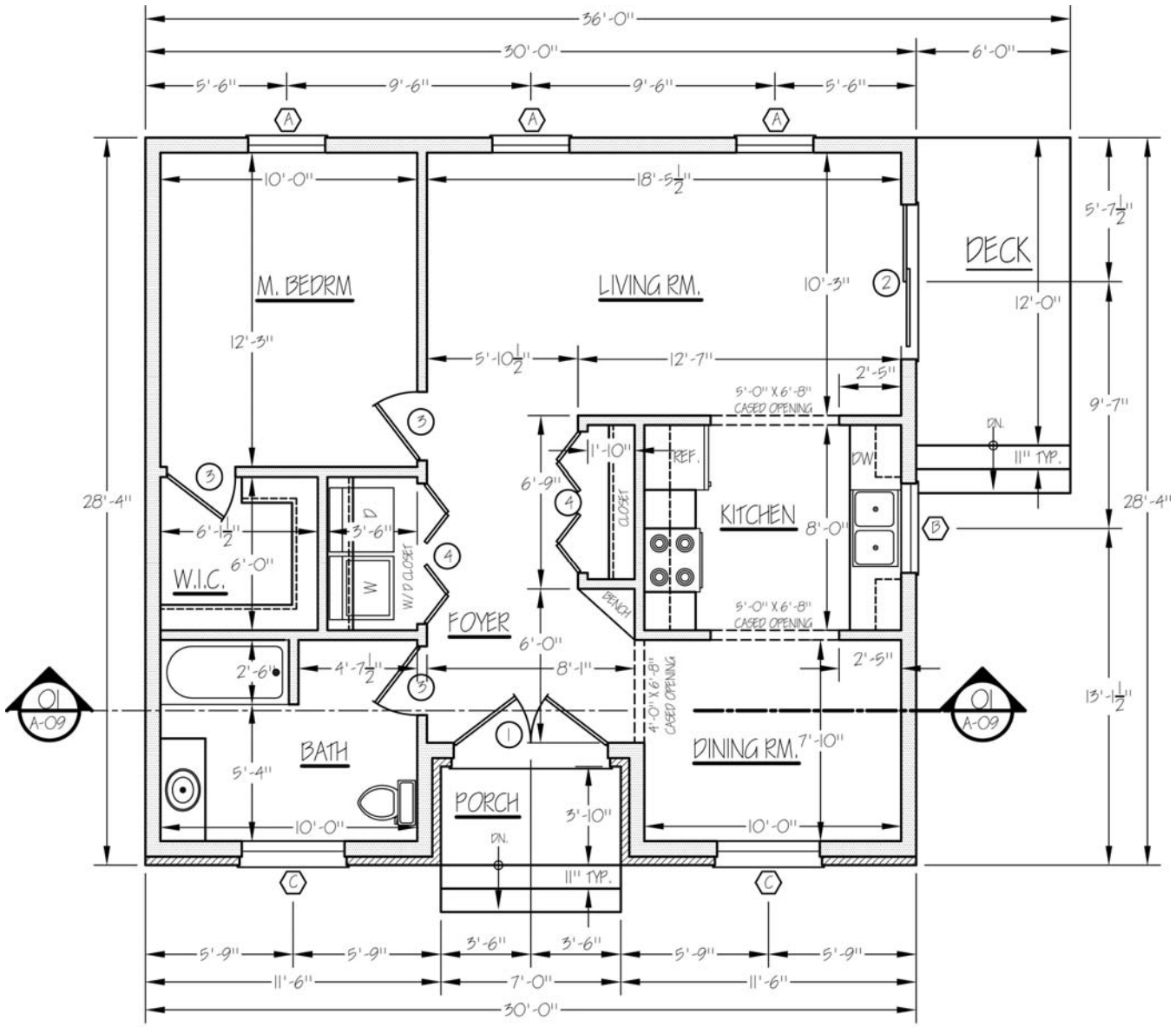

**FLOOR PLAN**  
 SCALE: 1/4" = 1'-0"